

Installation Guide

This procedure is designed as an installation aid. Skilled tradespeople that are familiar with general construction and electrical installation techniques should perform the installation. Licensed electricians should provide electrical installation connections. Installations and connections should be done in accordance with all national and local codes and permits. In no way is this document intended to construe warranty or fitness of use of the products described, nor is it intended to provide safety instruction for those installing the product.

⚡ WARNING

Before proceeding with installation or service maintenance of this product:

- Disconnect power to reduce electrical shock risk.
- Review the entire Installation Guide.
- Inspect this properly packaged product for any damage that may have occurred during transit.
- Verify product application complies with manufacturer design recommendations.
- Verify the availability of necessary tools and incidental material.
- Verify applicable code requirements. Field assembly and installation are subject to acceptance by local inspection authority.
- Appropriate safety equipment to be determined by end user, per applicable safety standards and precautions.

Installation

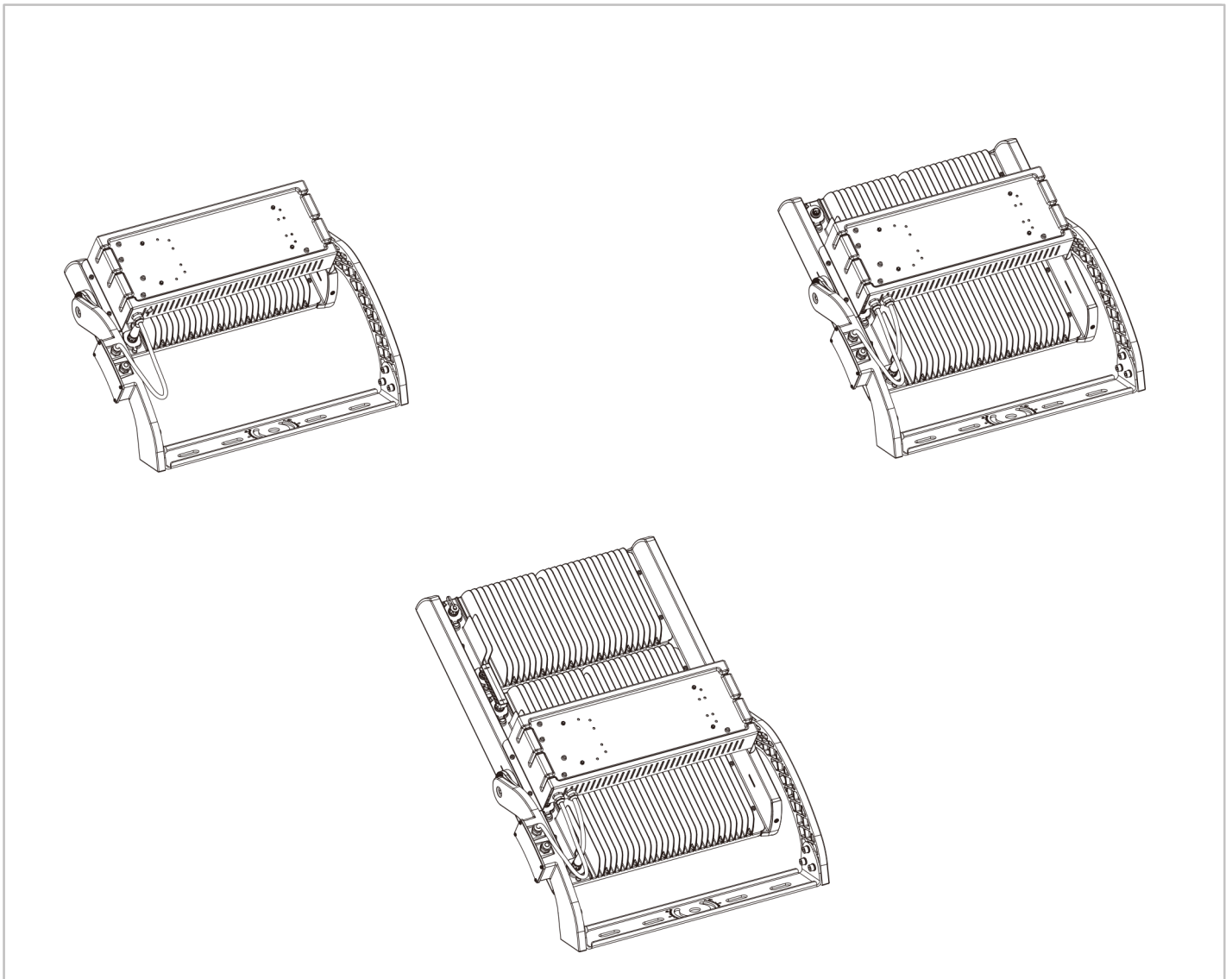

Installation procedure

I: Adjustable Angle signal

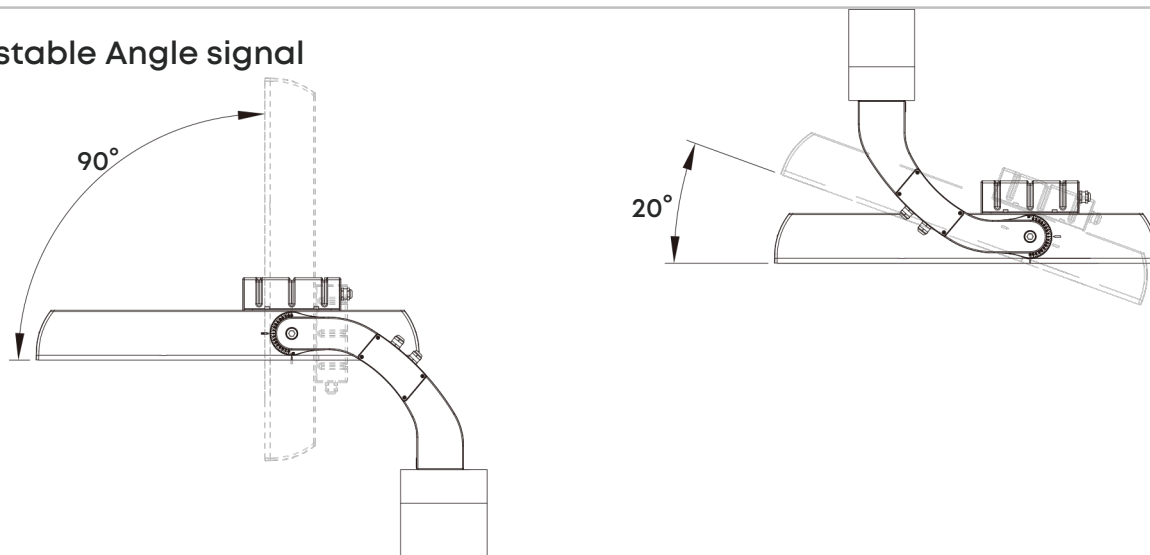

II: Tools



10# hex wrench



cross screwdriver



Wrench

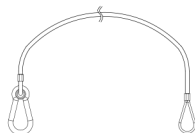

Safety rope
(one end already connected
to the lamp)

M12 Internal
Hexagon Bolt

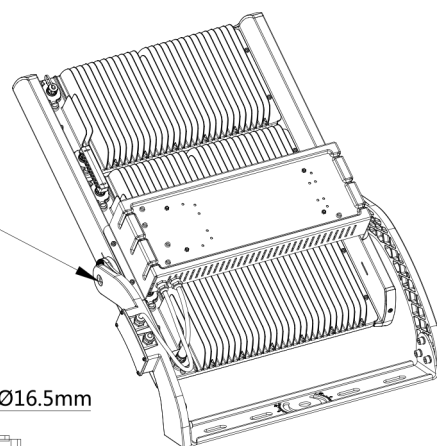
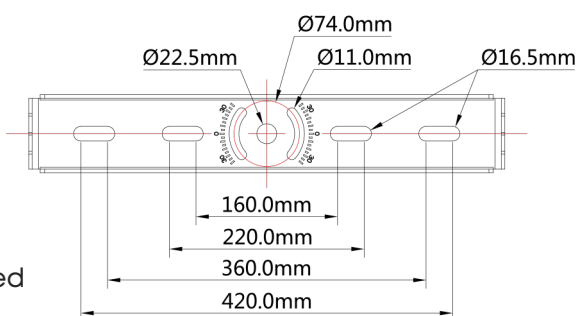

Attention:

Do not pull or drag from
non-handle area

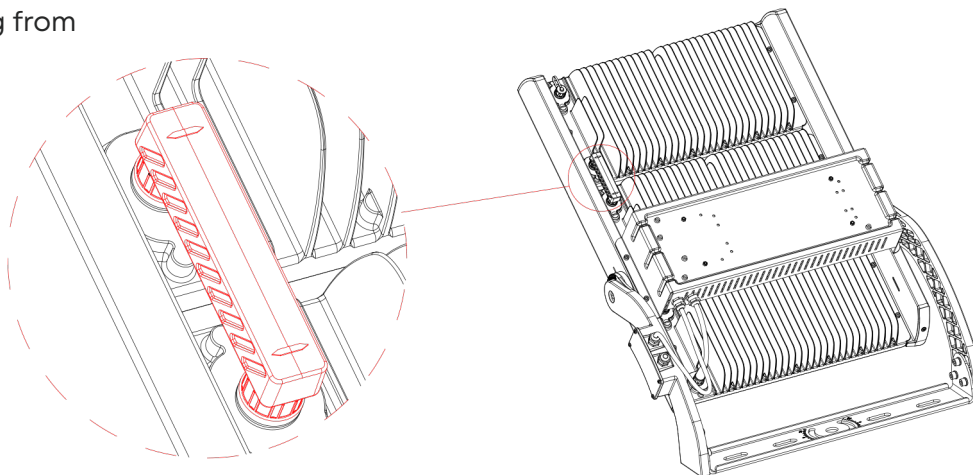

Matters Needing Attention

1. If installed as a single layer, according to the requirements of light distribution simulation, please pay attention when adjusting the direction of the lamps in the left and right directions to see if there is any mutual light blocking between the lamps;
2. If installed in a double-layer or multiple-layer configuration, according to the requirements of light distribution simulation, please pay attention to whether there is any mutual light blocking between the upper and lower lamps.

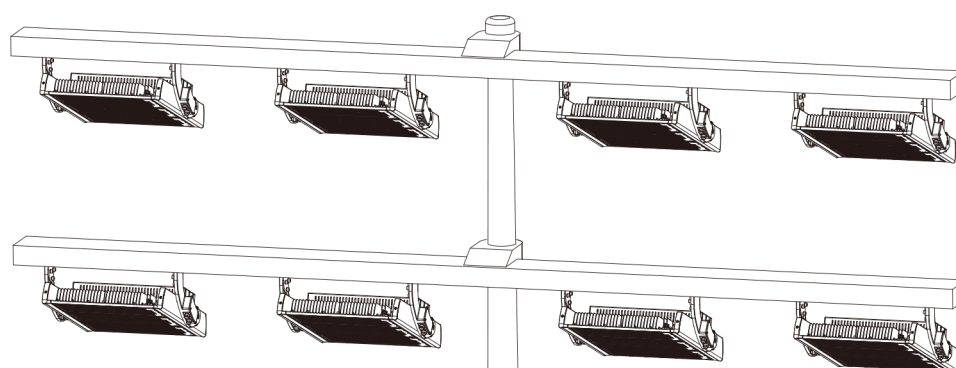
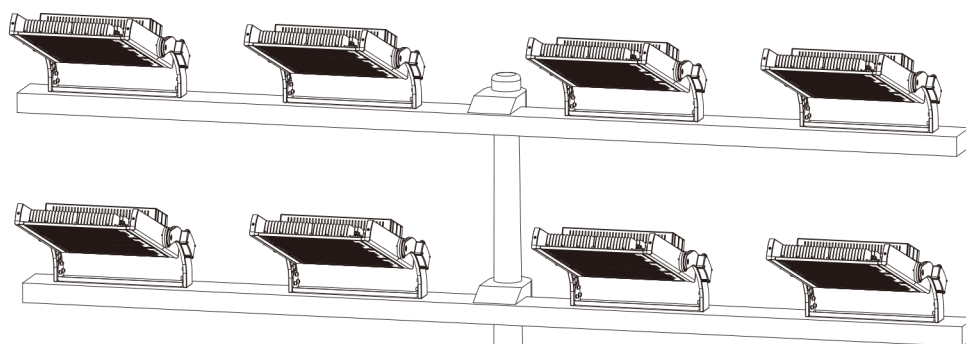

Installation Procedure

Mounting on the rod arm

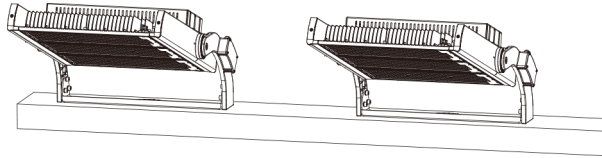

Step 1:

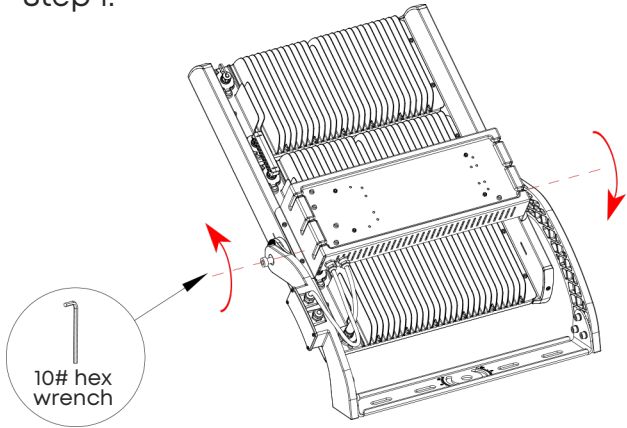

Step 2:

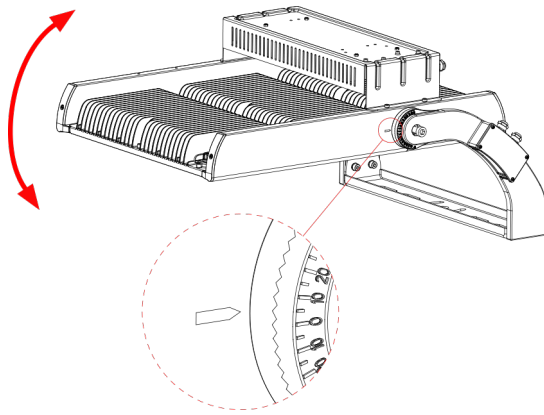

Step 3:

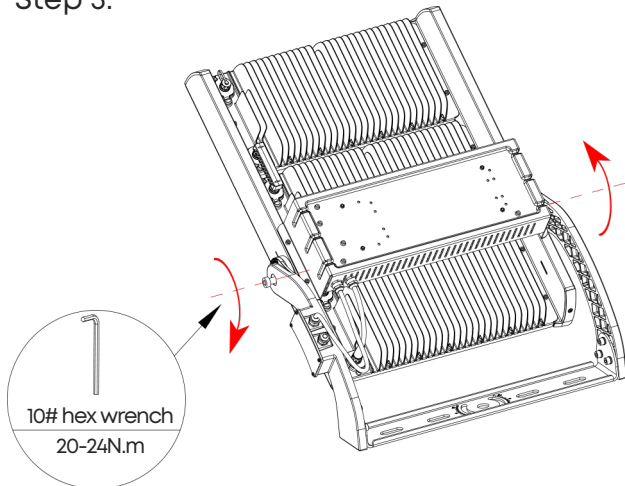

Mounting under the rod arm

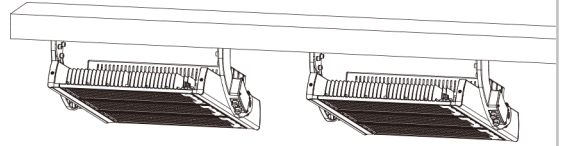

Step 1:

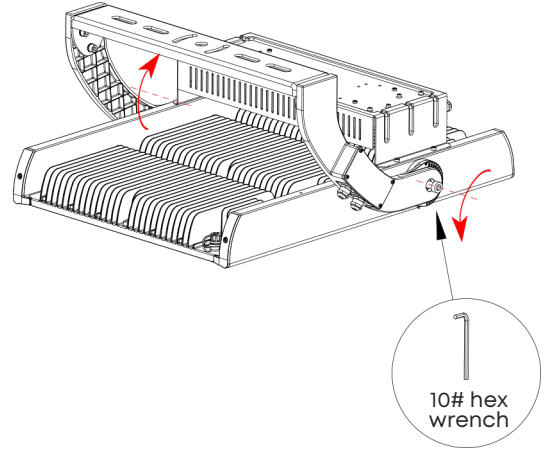

Step 2:

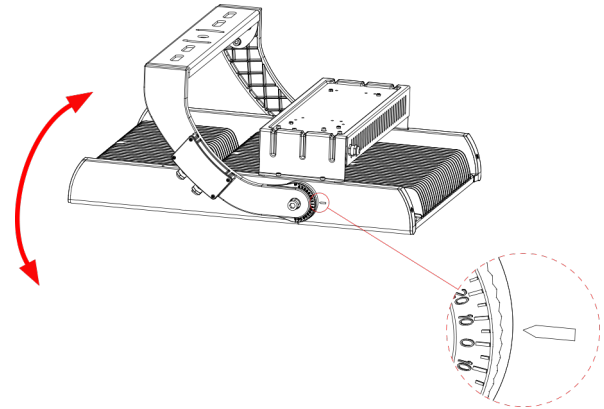

Step 3:

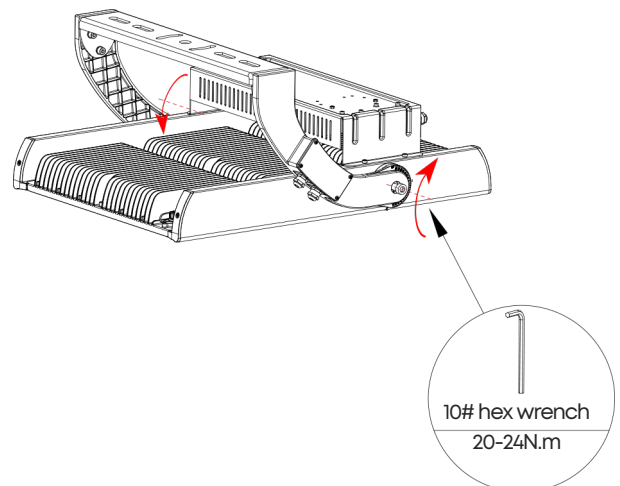

Lamp Horizontal Adjustment

Step 1:

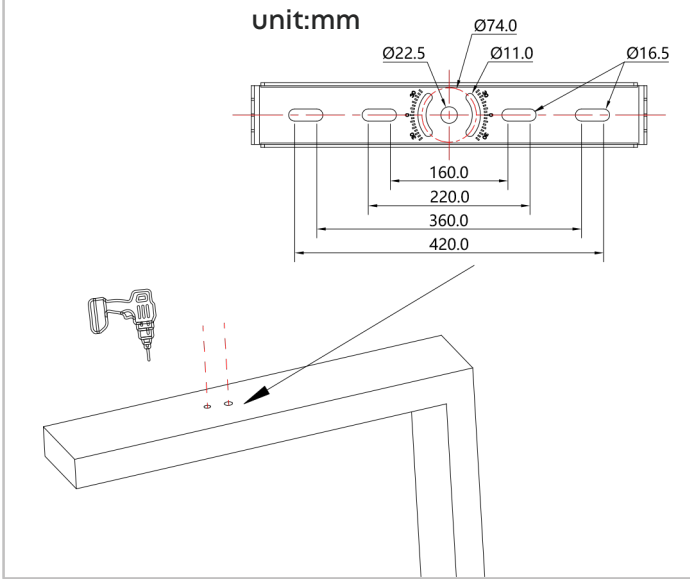

Step 2:

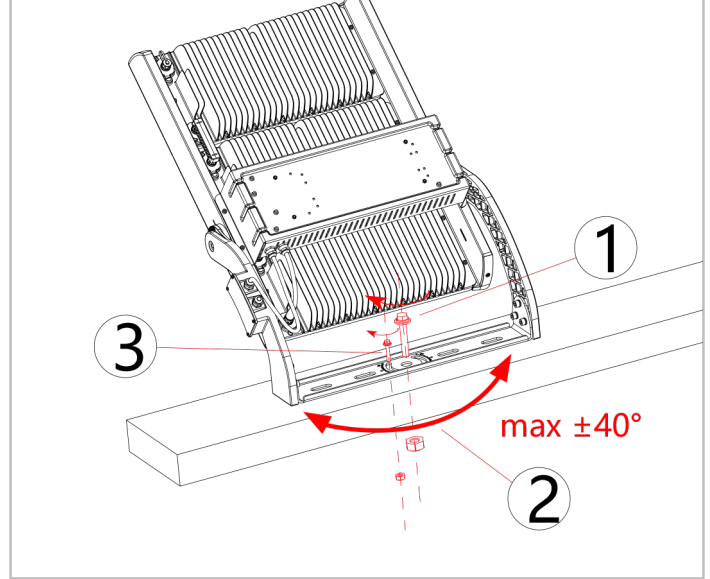

* If no horizontal adjustment angle is needed, it is recommended to lock the holes on both sides of the bracket.

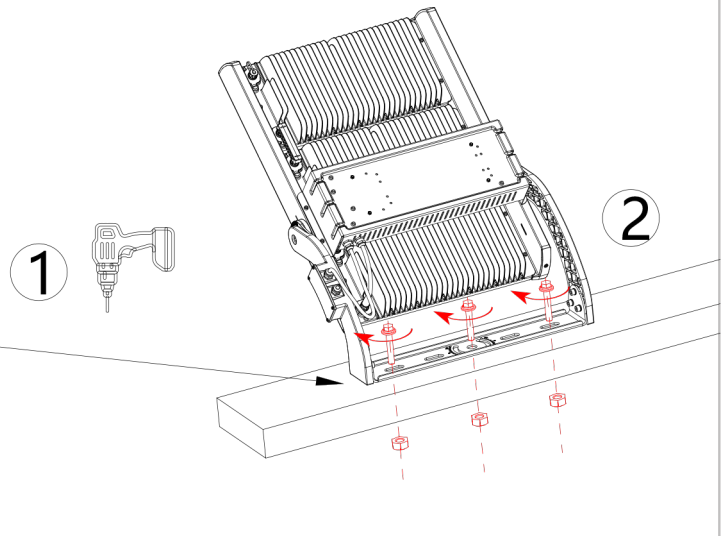
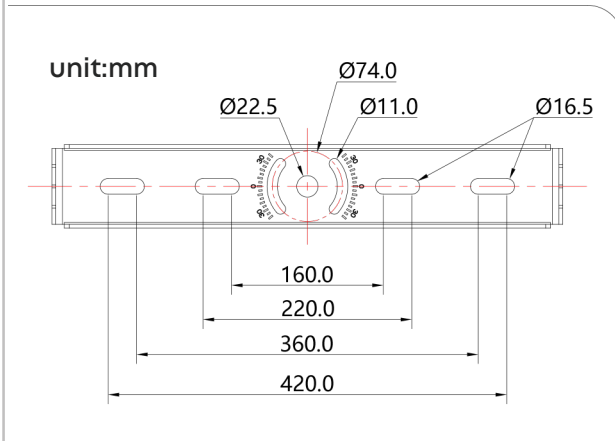

Install steel wire rope

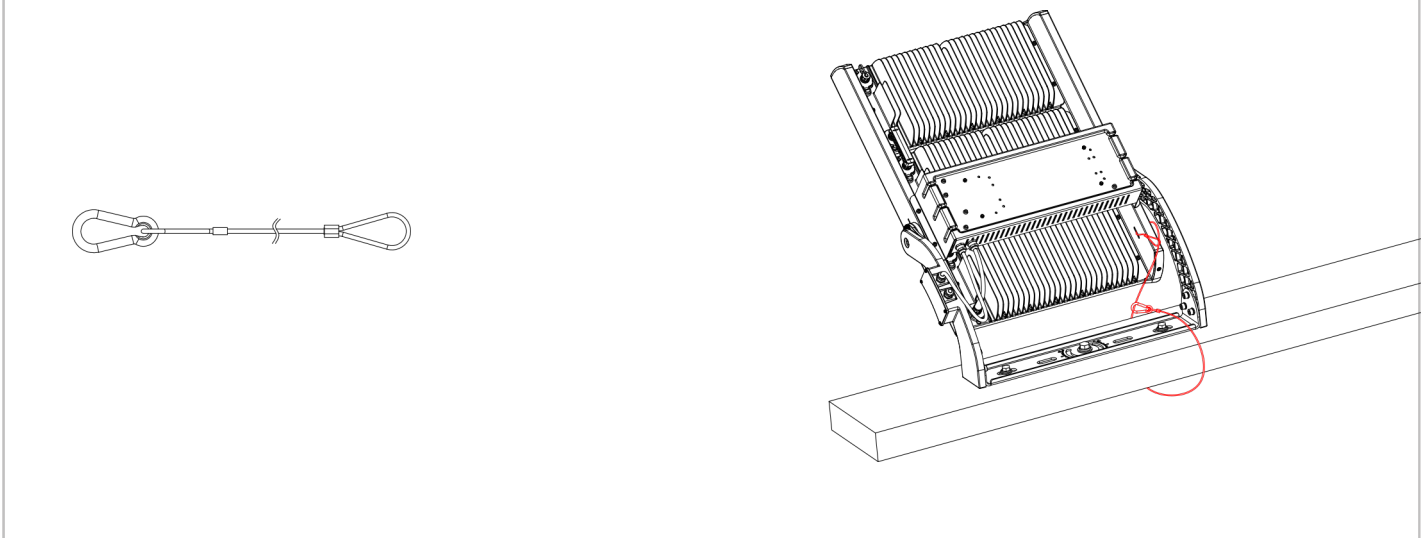

AC Terminal (Junction box)

Step 1:

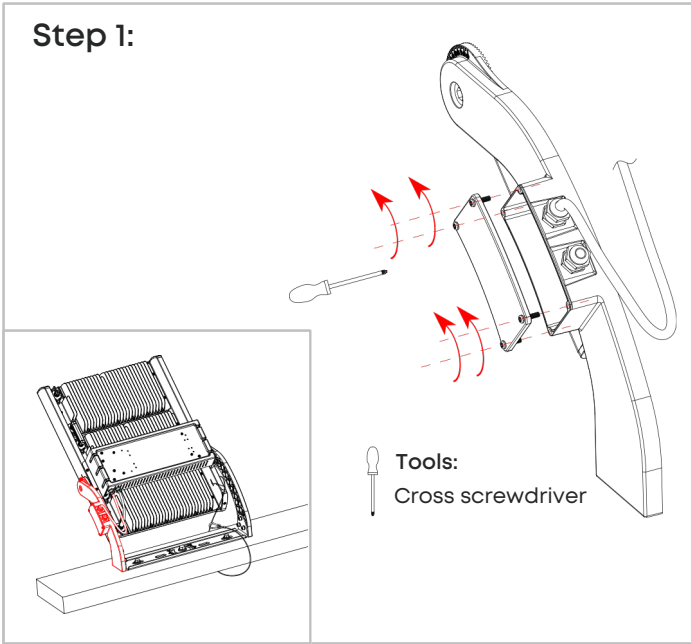

Step 2:

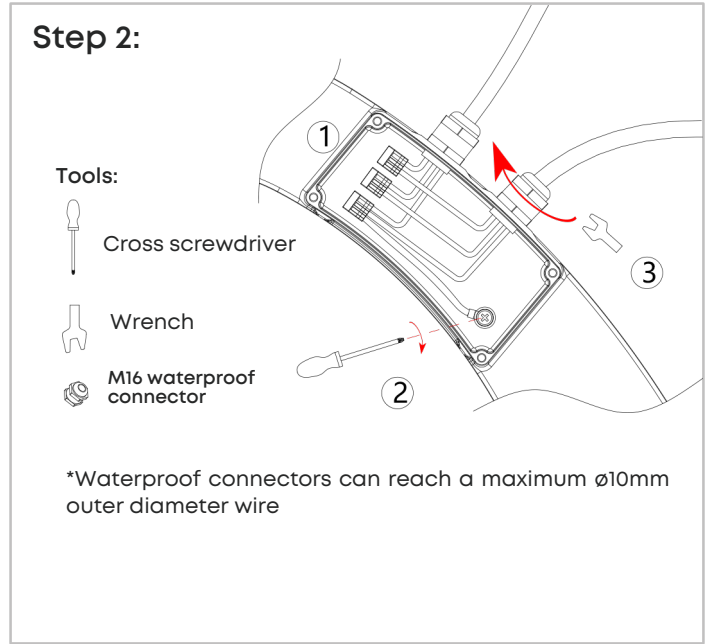

Step 3:

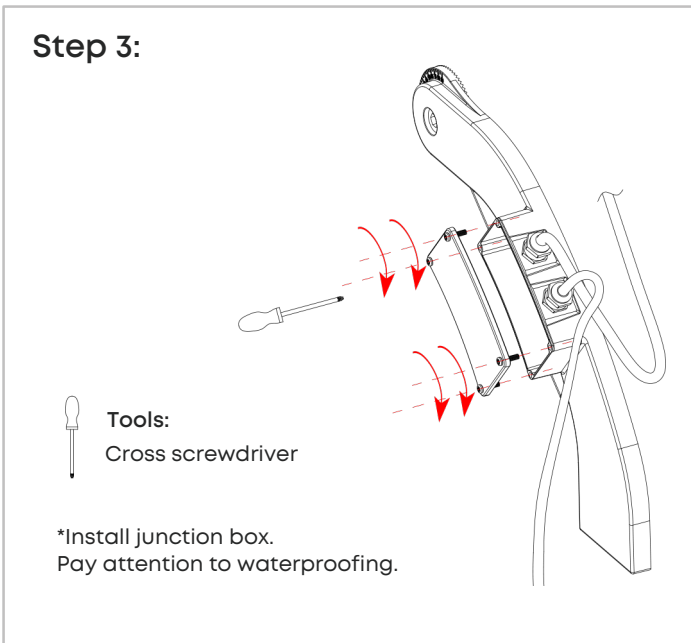

Step 4:

